

PRODUCT DATA SHEET

Burlington®

PRODUCT CODE
FC10BM

RANGE
Furniture

DESCRIPTION
Freestanding 1300 Vanity Unit Matt Black

WEBSITE LINK [Click Here](#)



CATEGORY	Furniture
WARRANTY DETAILS	10 Years
COLOUR	Matt Black
FINISH APPLICATION	Lacquered
PRIMARY MATERIAL	MDF
INSTALL TYPE	Floor Standing
PRODUCT WIDTH MM	1296
PRODUCT HEIGHT MM	820
PRODUCT DEPTH MM	548
PRODUCT NET WEIGHT KG	67.5

DRAWER BOX	MDF
DRAWER RUNNERS	Soft Close Drawer Runner
DRAWER EXTENSION	Half extension
DRAWER ADJUSTMENT	2 way adjustment
WALL HANGERS	Yes
ADJUSTABLE FEET	Yes
DRAWER CAPACITY	15kgs
DRAWER OPERATION	Soft close

TECHNICAL DIMENSIONS

Dimensions in mm unless otherwise specified.

Tolerances (per material type) apply.

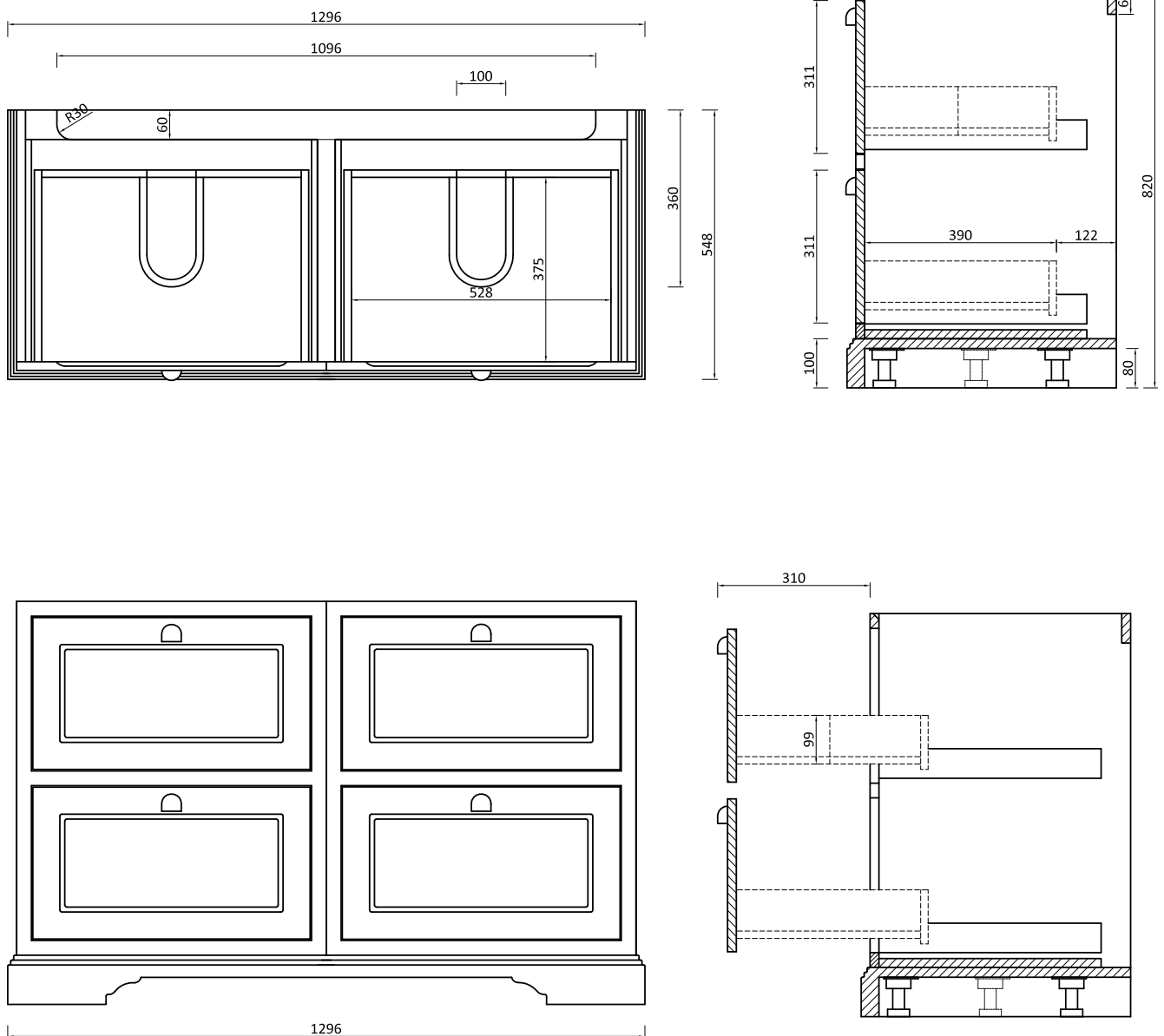

SPARES LIST

Only the parts labelled are available as spares.

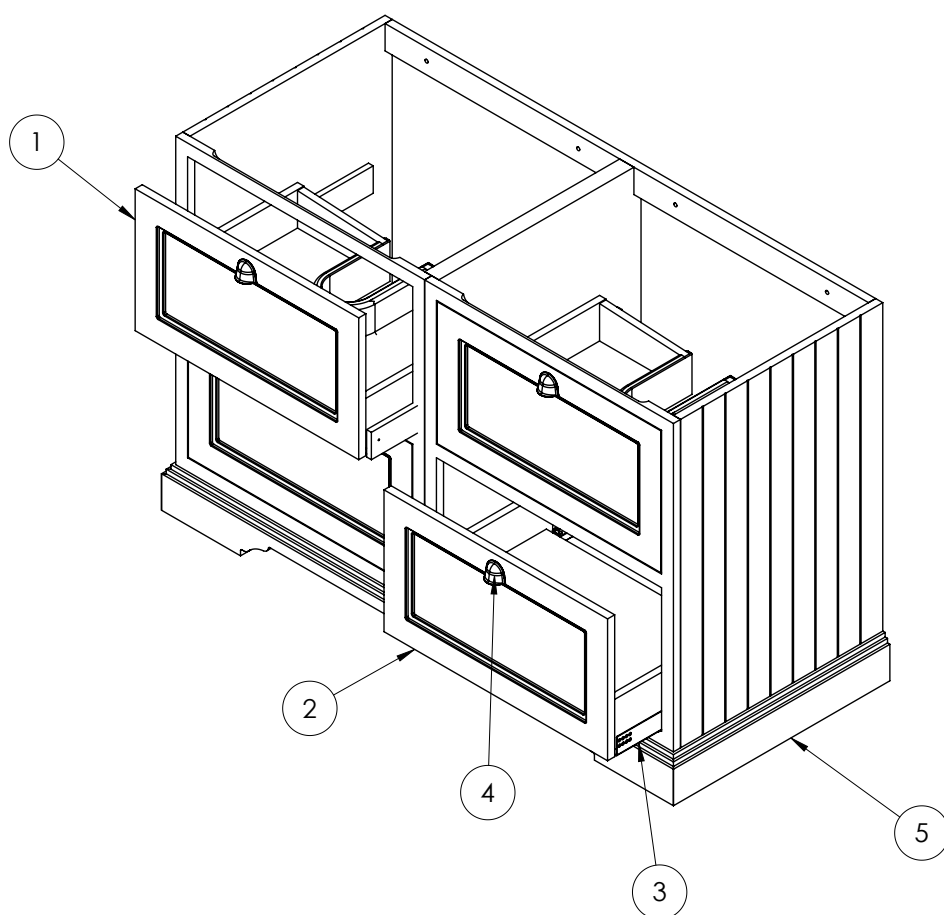

NUMBER	PART CODE	DESCRIPTION
1	SP998_BM	Top drawer (Panel & internal) for Burlington freestanding unit Matt Black
2	SP999_BM	Bottom drawer (Panel & internal) for Burlington freestanding unit Matt Black
3	SP670	Burl. Spare drawer runners for drawer un
4	SP653	1x handle 2x screws 2x washers Burling
5	P130BM	Plinth for Freestanding 130 Vanity Unit - Matt Black