

PRODUCT DATA SHEET



PRODUCT CODE
R3 BNKL

RANGE
Heating

DESCRIPTION
Cleaver Brushed Nickel Towel Warmer



CATEGORY	Heating
WARRANTY DETAILS	5 Years
COLOUR	Brushed Nickel
FINISH APPLICATION	PVD
PRIMARY MATERIAL	Steel
INSTALL TYPE	Wall Mounted
PRODUCT WIDTH MM	642
PRODUCT HEIGHT MM	677
PRODUCT DEPTH MM	235
PRODUCT NET WEIGHT KG	5.6
STANDARDS	BS EN 442-1:2015, BS EN 442-2:2015

INLET CONNECTIONS THREAD HEATING	G 1/2"
OUTPUT (WATTS)	164
FUEL TYPE	Central
PIPE CENTRES	440
PROJECTION	235
TUBE	Round
OUTPUT (BTU ΔT=50)	560
CUBIC CAPACITY (L)	2.2
TEMPERATURE RANGE	Maximum working temperature:95℃

TECHNICAL DIMENSIONS

Dimensions in mm unless otherwise specified.

Tolerances (per material type) apply.

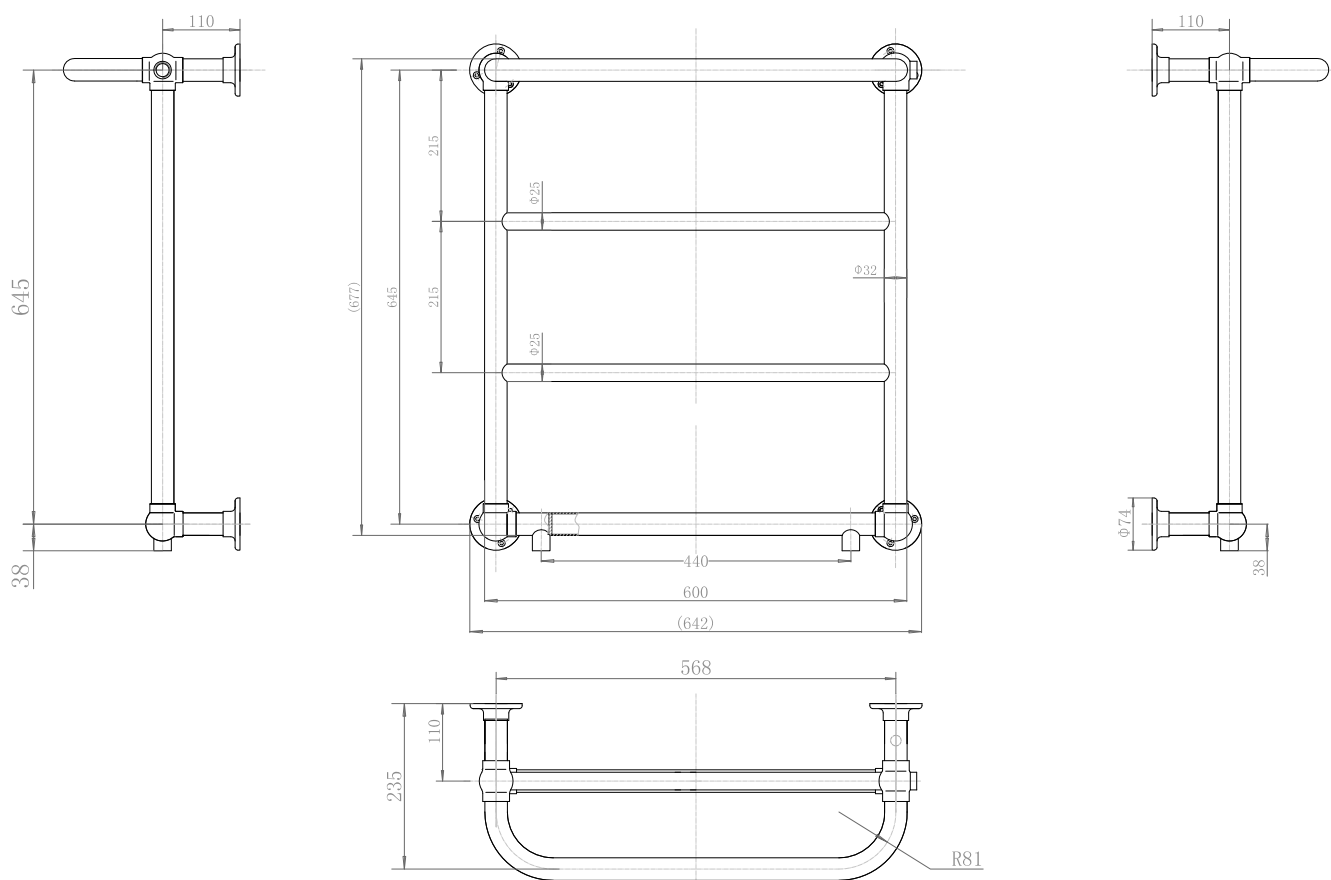

SPARES LIST

Only the parts labelled are available as spares.

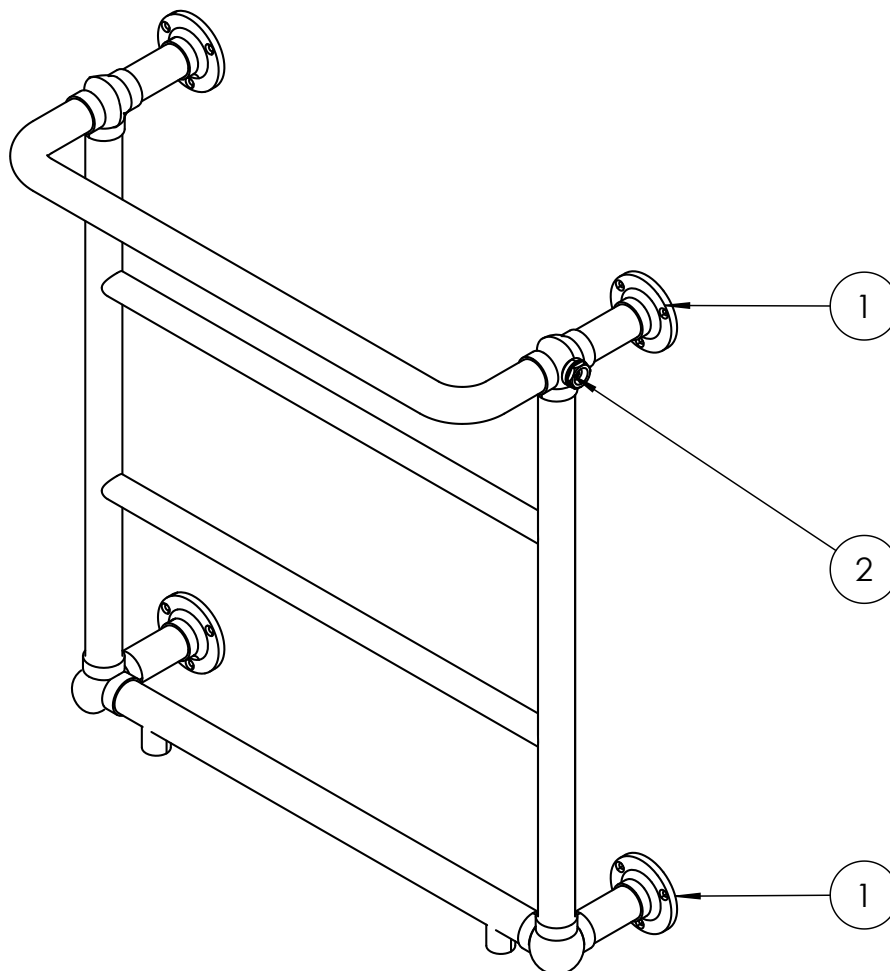

NUMBER	PART CODE	DESCRIPTION
1	SP555BNKL	complete set of fixings for R3 BNKL
2	SP801BNKL	Air valve for R1 BNKL, R2 BNKL, R3 BNKL, R4 BNKL