

PRODUCT DATA SHEET



PRODUCT CODE

T22A BNKL

RANGE

Furniture

DESCRIPTION

56cm/58cm Basin Wash Stand Brushed Nickel



CATEGORY	Furniture
WARRANTY DETAILS	15 Years
COLOUR	Brushed Nickel
FINISH APPLICATION	PVD
PRIMARY MATERIAL	Brass
INSTALL TYPE	Floor Mounted
PRODUCT WIDTH MM	535
PRODUCT HEIGHT MM	741
PRODUCT DEPTH MM	399
PRODUCT NET WEIGHT KG	3
STANDARDS	ISO9001

TECHNICAL DIMENSIONS

Dimensions in mm unless otherwise specified.

Tolerances (per material type) apply.

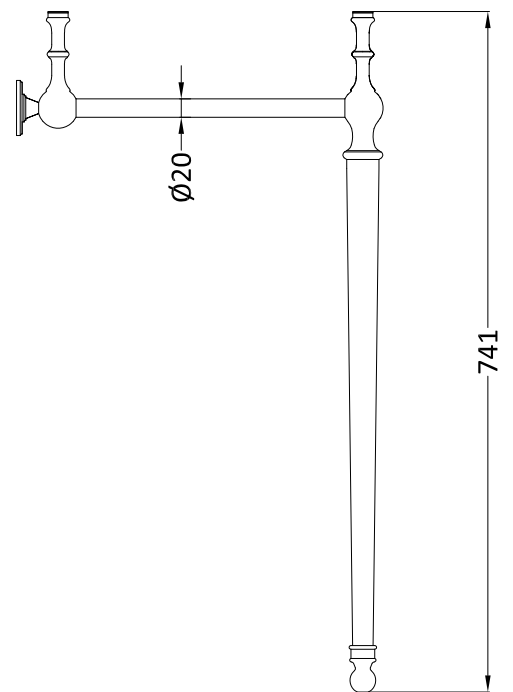
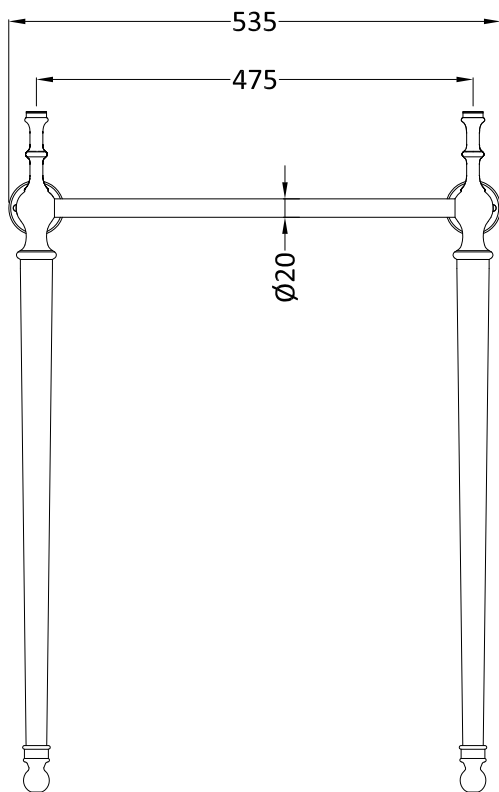
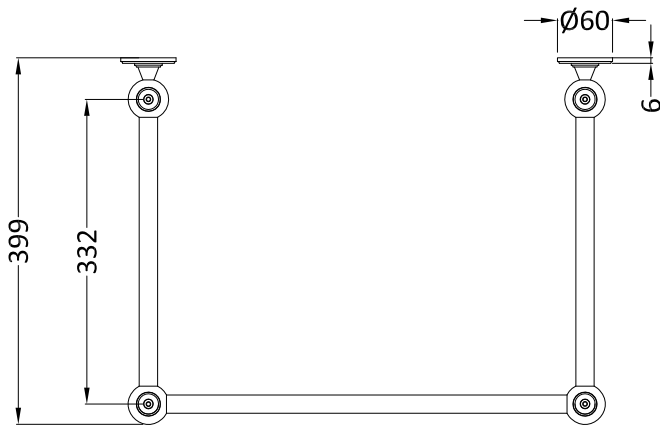

SPARES LIST

Only the parts labelled are available as spares.

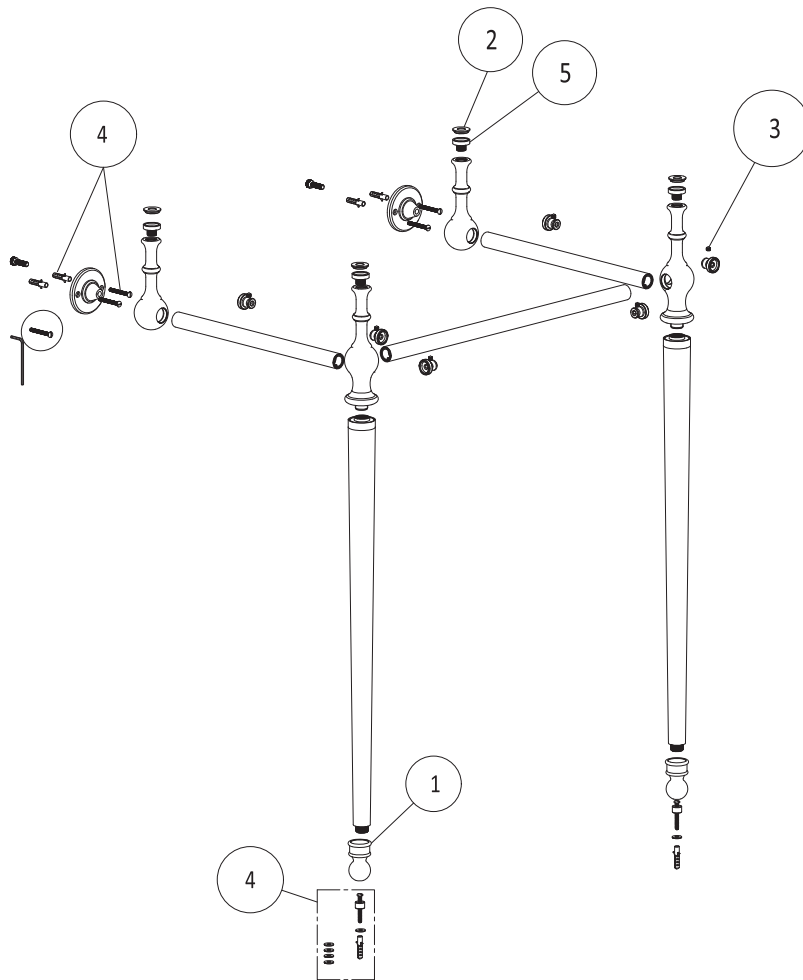

NUMBER	PART CODE	DESCRIPTION
1	SP838BNKL	Foot for Bur Basin Stands in Brushed Nickel
2	SP225	Rubber washer for basin stands
3	SP1587	Grub screw for the Burlington basin stand
4	SP824BNKL	Floor Fixings of Burlington Basin Stands Brushed Nickel
5	SP843BNKL	Adjust Screw of Burlington Basin Stands in Brushed Nickel