

PRODUCT DATA SHEET



PRODUCT CODE  
Z1205GOLD

RANGE  
Shower Waste

DESCRIPTION  
High Flow Shower Waste Gold



CATEGORY	Brassware
WARRANTY DETAILS	2 Years
COLOUR	Gold
FINISH APPLICATION	PVD
PRIMARY MATERIAL	ABS
PRODUCT WIDTH MM	130
PRODUCT HEIGHT MM	95
PRODUCT DEPTH MM	113
PRODUCT NET WEIGHT KG	0.31
STANDARDS	EN 274-1: 2002

WASTE WATER FLOW RATE	45.6
WATER SEAL HEIGHT (MM)	51.34

PRESSURE (BAR)	0.2	0.5	1	2	3	4	5
PRIMARY FLOWRATE							
HANDSET FLOWRATE							
MASSAGE FLOW RATE							
AIR FLOW RATE							
WIRE FLOW RATE							
WATERFALL FLOW RATE							
MIST FLOW RATE							
HANDSPRAY FLOW RATE							

## TECHNICAL DIMENSIONS

Dimensions in mm unless otherwise specified.

Tolerances (per material type) apply.

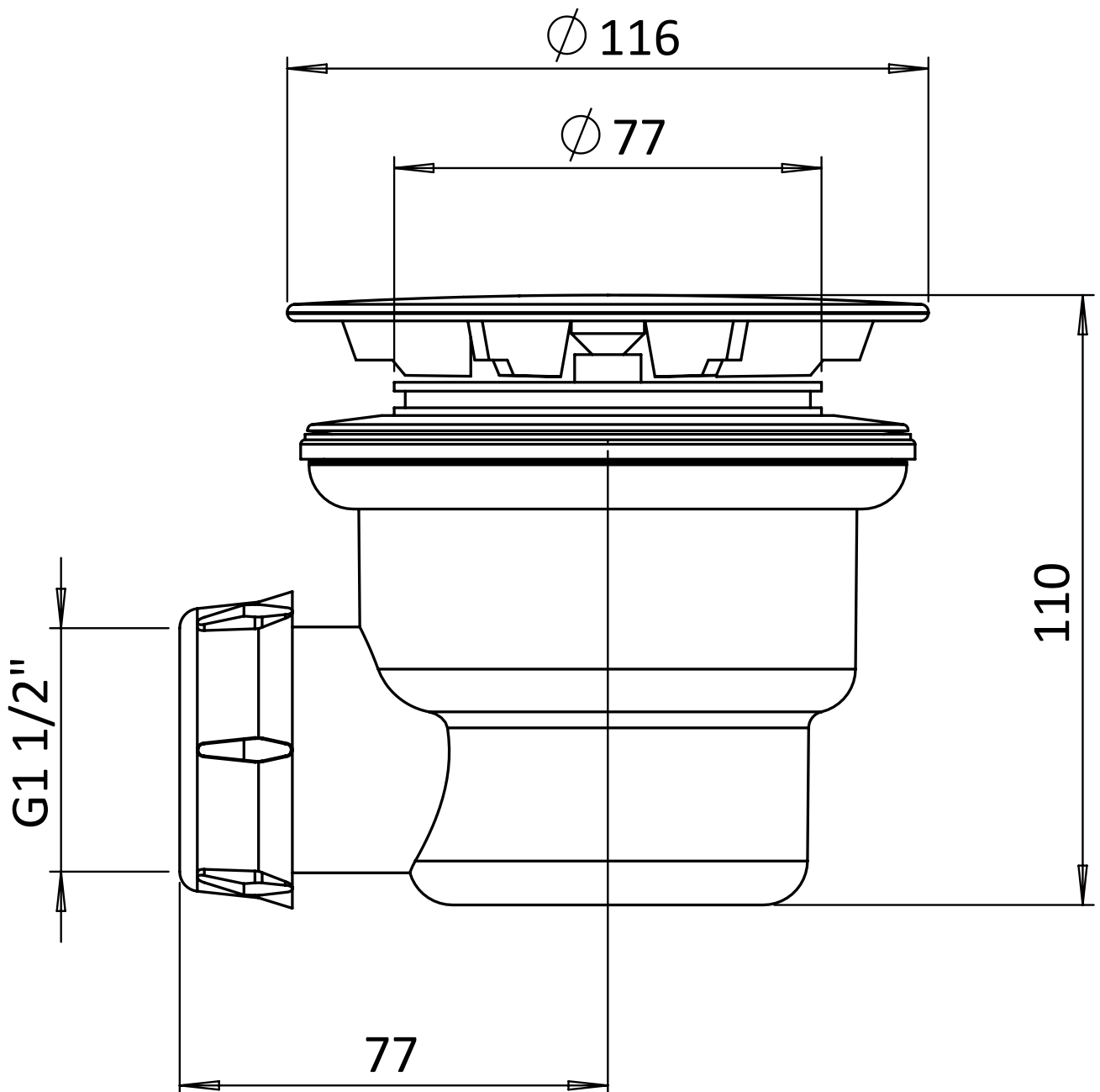

## SPARES LIST

Only the parts labelled are available as spares.

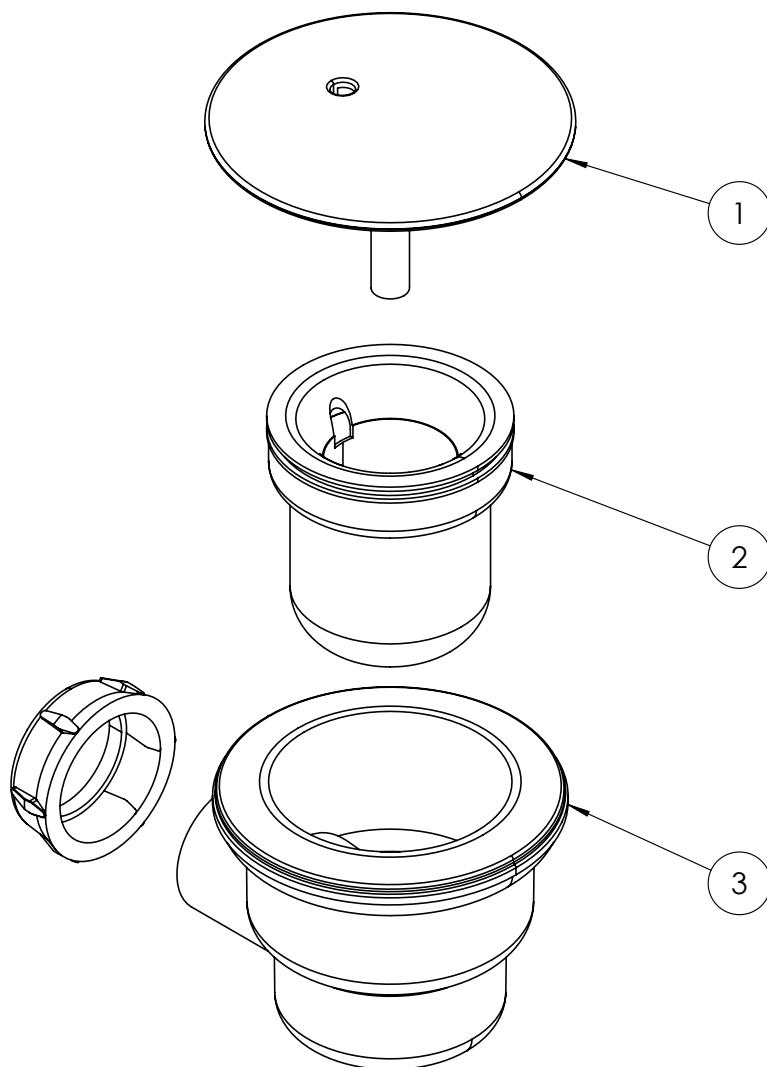

NUMBER	PART CODE	DESCRIPTION
1	ZSP1	Chrome Domed Cover for Waste
2	SP190	Dip Tube of HFW
3	SP154	HFWC Seal, Including 3 Type of Seals
	SP978	Spare Waste Tool For Z1205
	SP1319	Clear O-Ring On The Dip Tube of Waste Z1