

PRODUCT DATA SHEET

Burlington®

PRODUCT CODE
E11 BNKL

RANGE
Burlington

DESCRIPTION
Traditional Leg Set Brushed Nickel

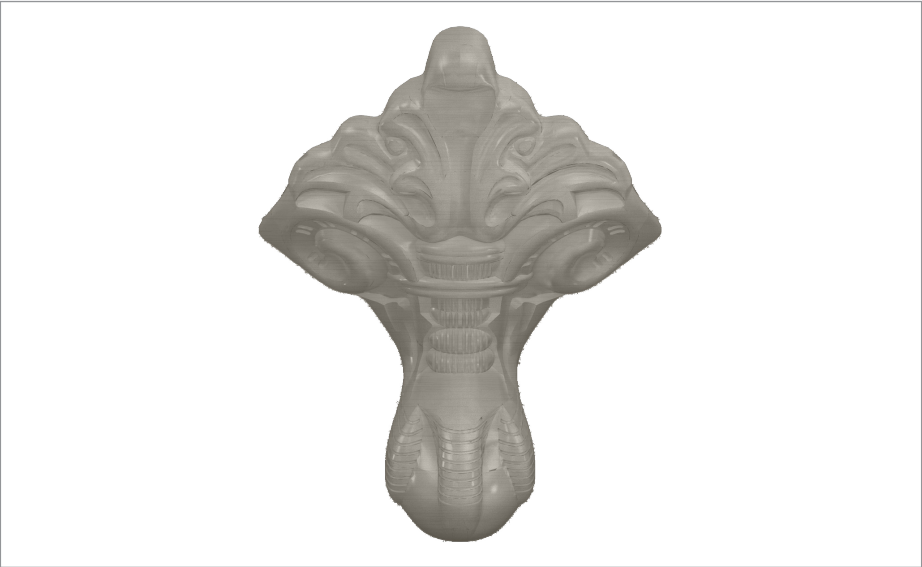

| | |
|-----------------------|----------------|
| CATEGORY | Baths |
| WARRANTY DETAILS | 15 Years |
| COLOUR | Brushed Nickel |
| FINISH APPLICATION | PVD |
| PRIMARY MATERIAL | Aluminum |
| INSTALL TYPE | Floor Standing |
| PRODUCT WIDTH MM | 179 |
| PRODUCT HEIGHT MM | 262 |
| PRODUCT DEPTH MM | 166 |
| PRODUCT NET WEIGHT KG | 3.2 |

TECHNICAL DIMENSIONS

Dimensions in mm unless otherwise specified.

Tolerances (per material type) apply.

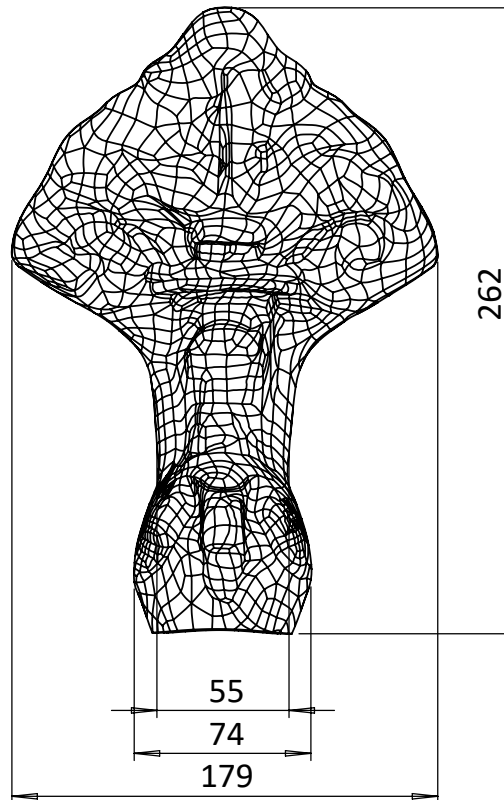
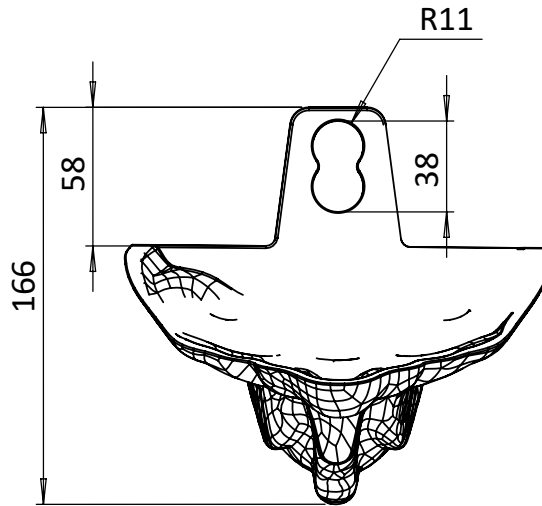

SPARES LIST

Only the parts labelled are available as spares.

NO SPARES AVAILABLE