

PRODUCT DATA SHEET

Burlington®

PRODUCT CODE
FF9MG

RANGE
Furniture

DESCRIPTION
Freestanding Basin Unit Drawers Matt Green



CATEGORY	Furniture
WARRANTY DETAILS	10 Years
COLOUR	Matt Green
FINISH APPLICATION	Lacquered
PRIMARY MATERIAL	MDF
INSTALL TYPE	Floor Standing
PRODUCT WIDTH MM	666
PRODUCT HEIGHT MM	820
PRODUCT DEPTH MM	548
PRODUCT NET WEIGHT KG	34
STANDARDS	EN14749:2016

COLOUR CODE / REFERENCE	NCS S7020 - B70G
DRAWER BOX	MDF
DRAWER RUNNERS	DTC G10-400-H-X/GJS02
DRAWER EXTENSION	Half extension
DRAWER ADJUSTMENT	2 way adjustment
WALL HANGERS	Yes
ADJUSTABLE FEET	Yes
DRAWER CAPACITY	15kgs
DRAWER OPERATION	Soft close

TECHNICAL DIMENSIONS

Dimensions in mm unless otherwise specified.
Tolerances (per material type) apply.

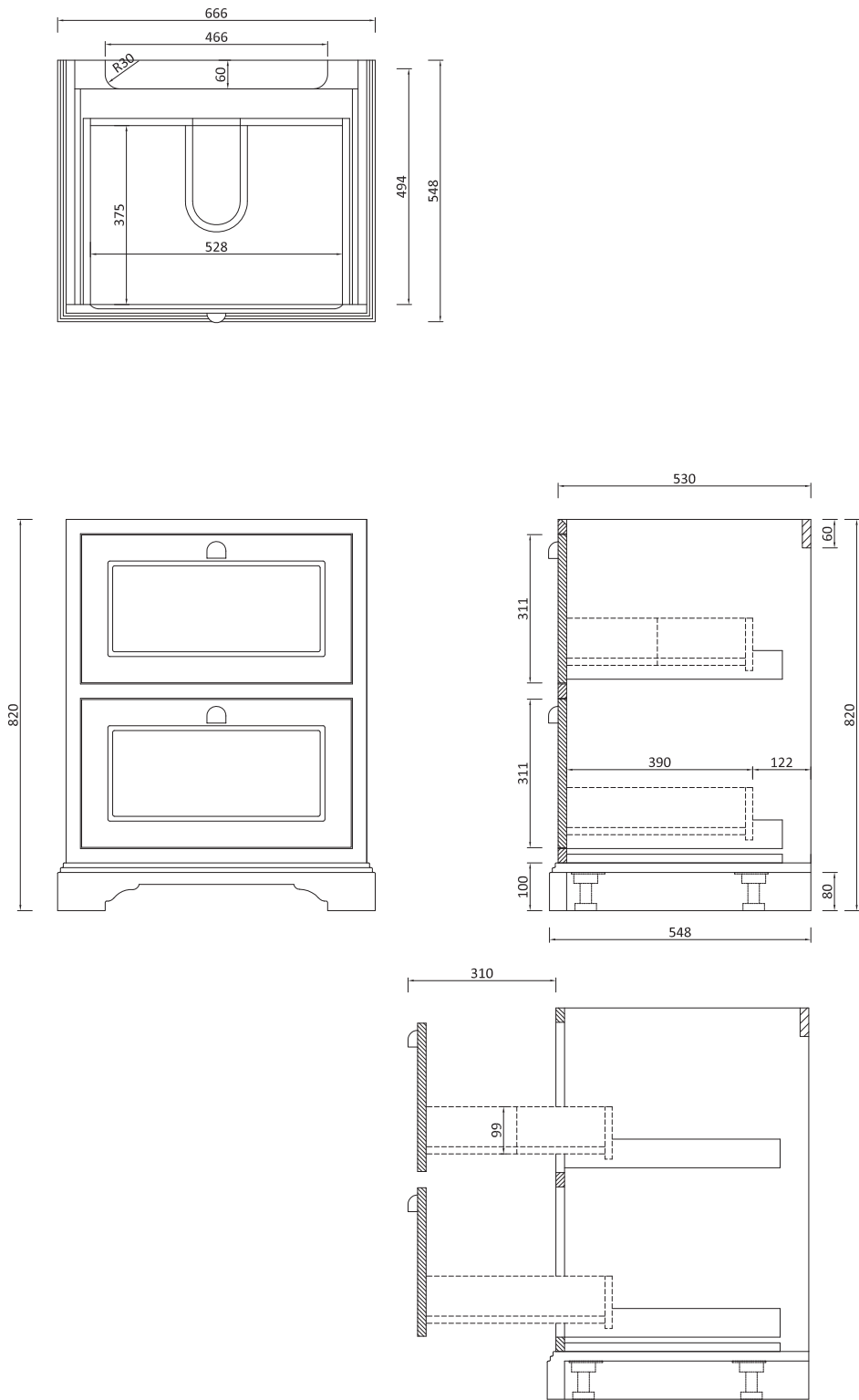

SPARES LIST

Only the parts labelled are available as spares.

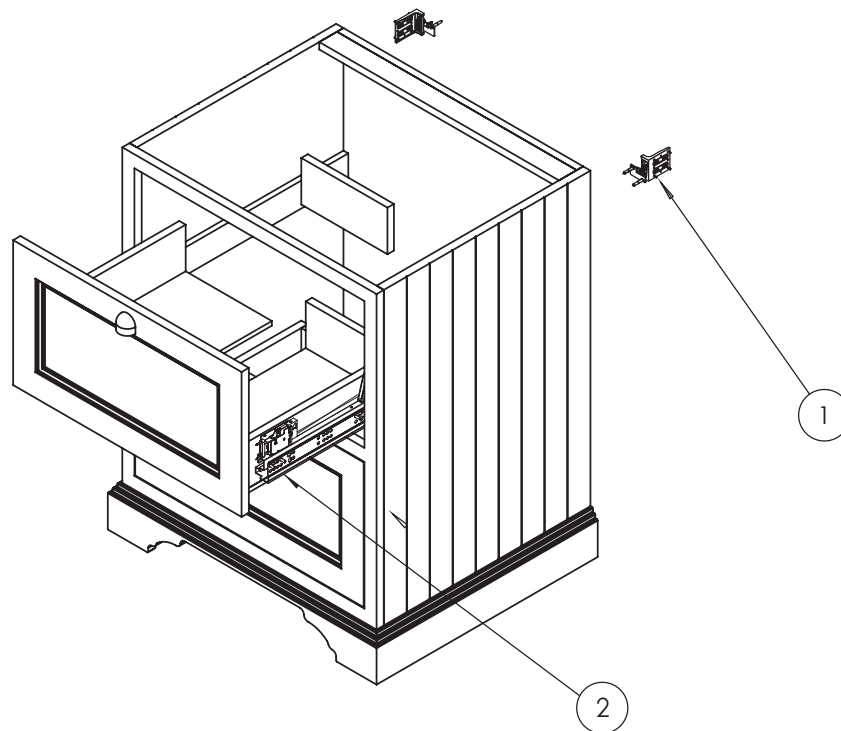

NUMBER	PART CODE	DESCRIPTION
1	SP653	1x handle 2x screws 2x washers Burling
2	SP669	Burl. Spare adjustable leg for floor uni
3	SP762	Burlington rectangular glass shelf for F
4	SP945	Burlington spare screws & fixings for fu
5	SP949	Burlington spare furniture hinges (Pair)
6	SPFF8GS	Burl. Spare glass shelf for FF8,FC1,FC2