

PRODUCT DATA SHEET

Burlington®

PRODUCT CODE
FC13G

RANGE
Furniture

DESCRIPTION
Freestanding Basin Unit 750 Doors Matt Grey



| | |
|-----------------------|----------------|
| CATEGORY | Furniture |
| WARRANTY DETAILS | 10 Years |
| COLOUR | Matt Grey |
| FINISH APPLICATION | Lacquered |
| PRIMARY MATERIAL | MDF |
| INSTALL TYPE | Floor Standing |
| PRODUCT WIDTH MM | 786 |
| PRODUCT HEIGHT MM | 820 |
| PRODUCT DEPTH MM | 548 |
| PRODUCT NET WEIGHT KG | 37 |
| STANDARDS | EN14749:2016 |

| | |
|-------------------|-------------------------|
| DRAWER BOX | MDF |
| DRAWER RUNNERS | DTC HINGE |
| DRAWER EXTENSION | FULL EXTENSION |
| DRAWER ADJUSTMENT | 2 way adjustment |
| WALL HANGERS | YES |
| ADJUSTABLE FEET | Yes |
| DRAWER CAPACITY | 15KGS |
| DRAWER OPERATION | Soft close Pull to open |

TECHNICAL DIMENSIONS

Dimensions in mm unless otherwise specified.
Tolerances (per material type) apply.

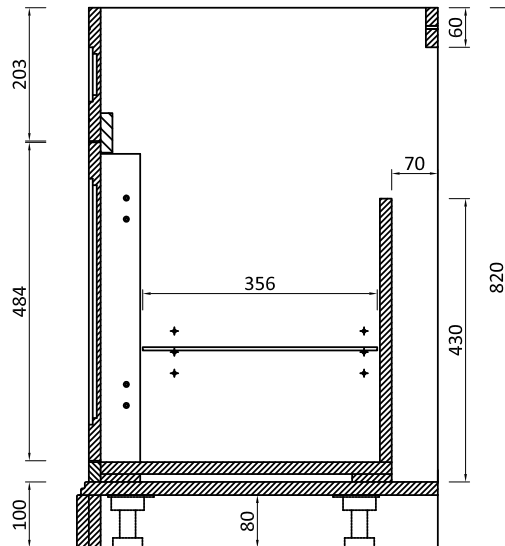
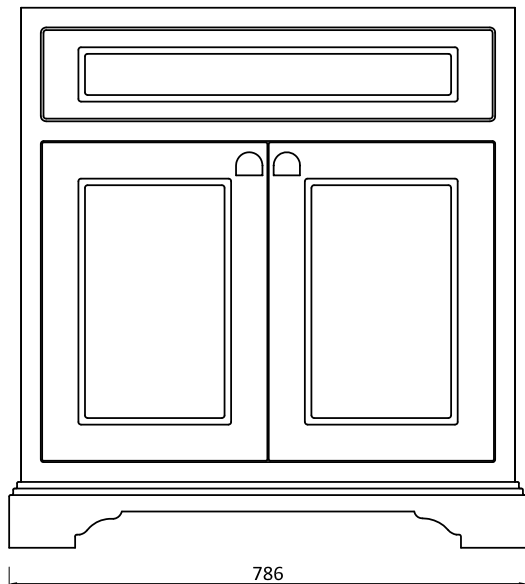
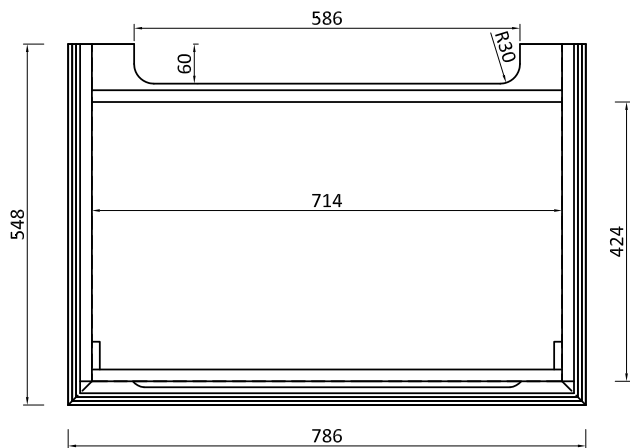

SPARES LIST

Only the parts labelled are available as spares.

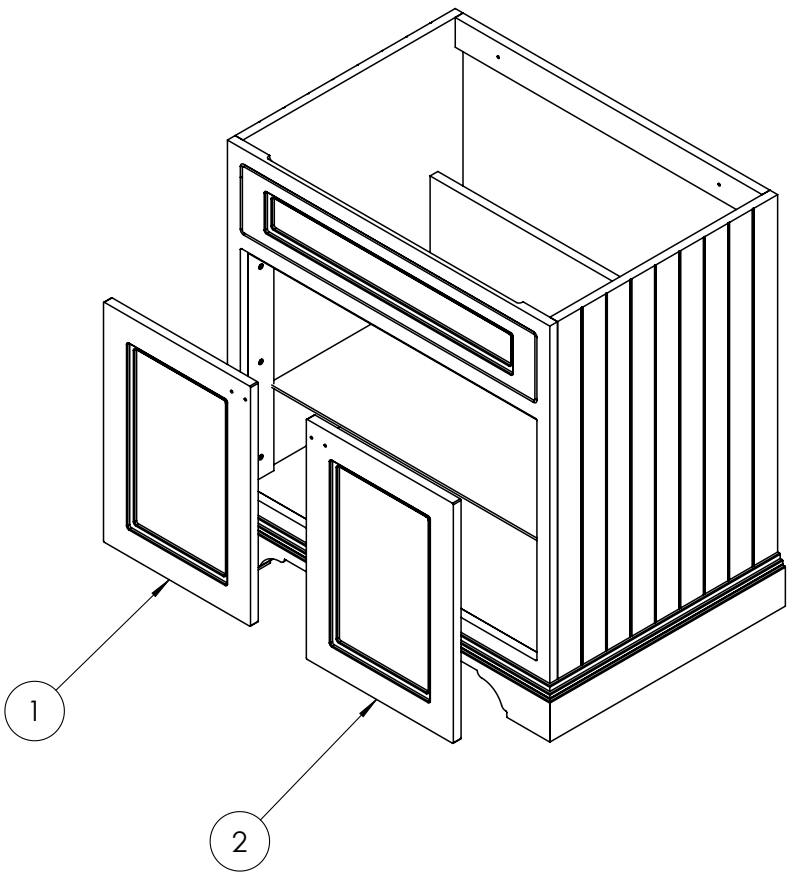

| NUMBER | PART CODE | DESCRIPTION |
|--------|--------------|-------------------------------|
| 1 | SP1749-W-LH | Burlington Door LH for FC13W |
| | SP1749-B-LH | Burlington Door LH for FC13B |
| | SP1749-MG-LH | Burlington Door LH for FC13MG |
| | SP1749-G-LH | Burlington Door LH for FC13G |
| 2 | SP1749-W-RH | Burlington Door RH for FC13W |
| | SP1749-B-RH | Burlington Door RH for FC13B |
| | SP1749-MG-RH | Burlington Door RH for FC13MG |
| | SP1749-G-RH | Burlington Door RH for FC13G |