

PRODUCT DATA SHEET

Burlington®

PRODUCT CODE
FC10MG

RANGE
Furniture

DESCRIPTION
1300 Freestanding Vanity Unit Matt Green



CATEGORY	Furniture
WARRANTY DETAILS	10 Years
COLOUR	Matt Green
FINISH APPLICATION	Lacquered
PRIMARY MATERIAL	MDF
INSTALL TYPE	Floor Standing
PRODUCT WIDTH MM	1296
PRODUCT HEIGHT MM	820
PRODUCT DEPTH MM	548
PRODUCT NET WEIGHT KG	67.5
STANDARDS	EN14749:2016

COLOUR CODE / REFERENCE	NCS S7020 - B70G
DRAWER BOX	MDF
DRAWER RUNNERS	DTC G10-400-H-X/GJS02
DRAWER EXTENSION	Half extension
WALL HANGERS	Yes
ADJUSTABLE FEET	Yes
DRAWER CAPACITY	15kgs
DRAWER OPERATION	Soft close

TECHNICAL DIMENSIONS

Dimensions in mm unless otherwise specified.

Tolerances (per material type) apply.

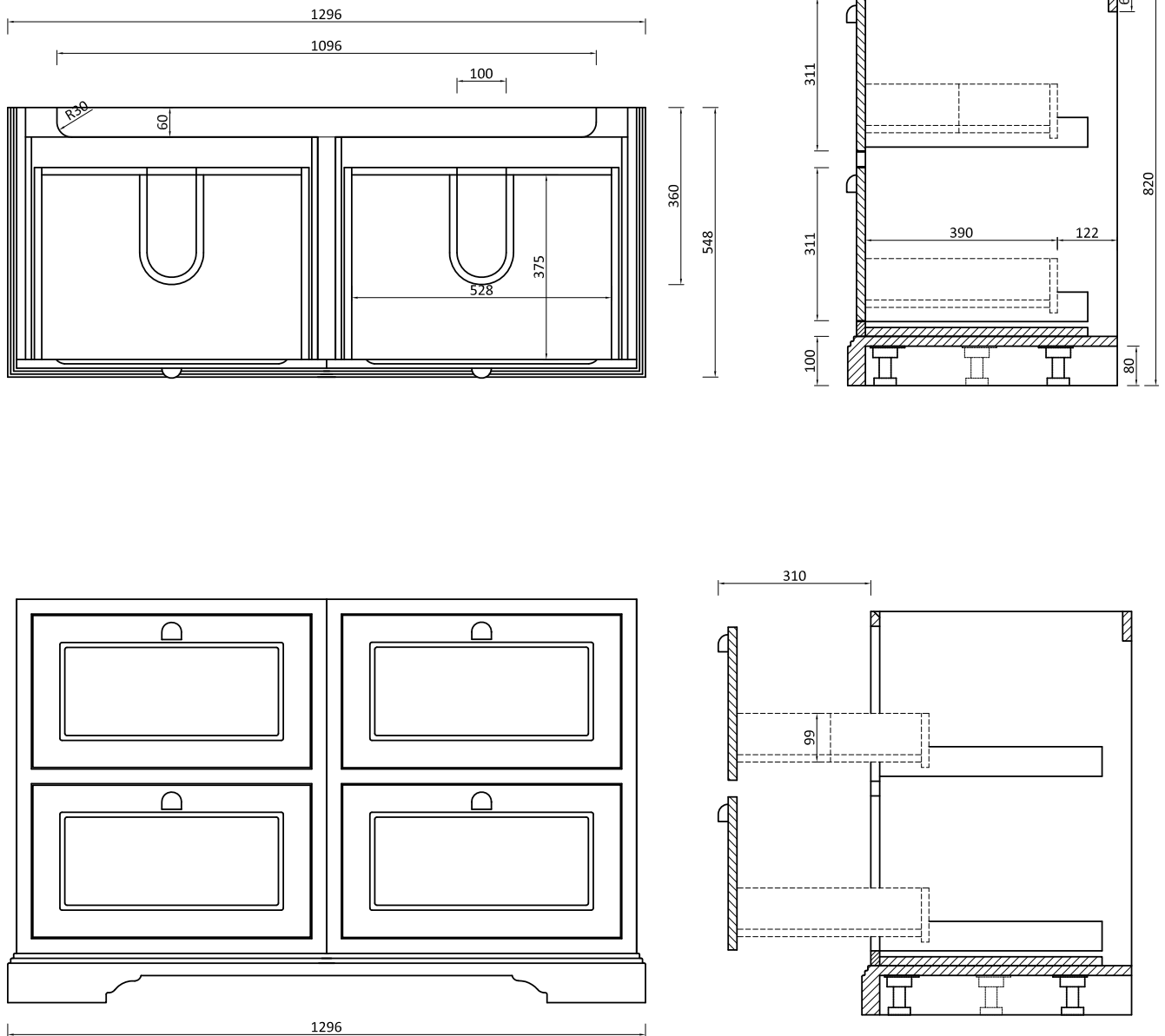

SPARES LIST

Only the parts labelled are available as spares.

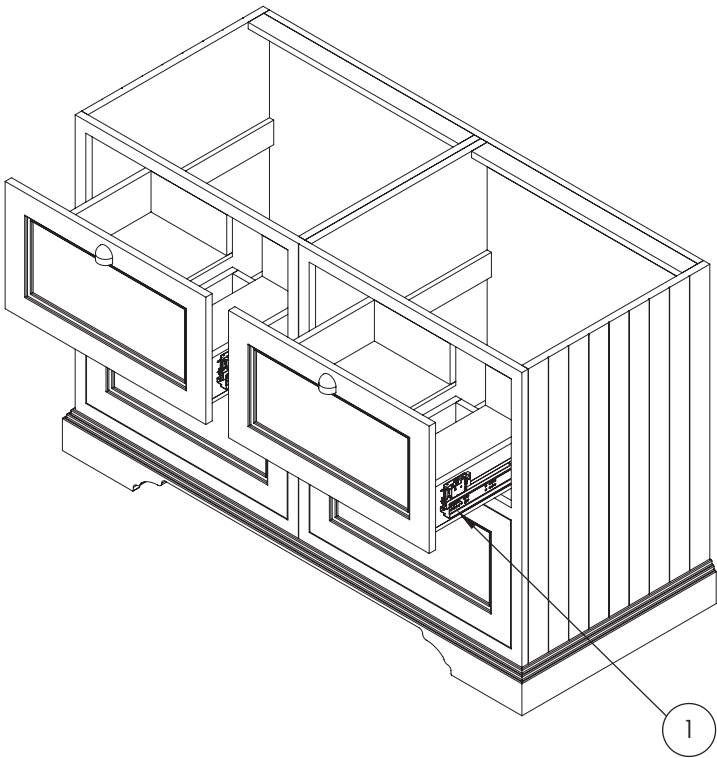

NUMBER	PART CODE	DESCRIPTION
1	SP670	Burl. Spare drawer runners for drawer