

PRODUCT DATA SHEET

Burlington®

PRODUCT CODE
FC12MG

RANGE
Furniture

DESCRIPTION
Edwardian Freestanding Matt Green



CATEGORY	Furniture
WARRANTY DETAILS	10 Years
COLOUR	Matt Green
FINISH APPLICATION	Lacquered
PRIMARY MATERIAL	MDF
INSTALL TYPE	Floor Standing
PRODUCT WIDTH MM	556
PRODUCT HEIGHT MM	737
PRODUCT DEPTH MM	470
PRODUCT NET WEIGHT KG	24
STANDARDS	EN14749:2016

COLOUR CODE / REFERENCE	NCS S7020 - B70G
DRAWER BOX	MDF
DRAWER RUNNERS	DTC HINGE
DRAWER EXTENSION	FULL EXTENSION
DRAWER ADJUSTMENT	2 way adjustment
WALL HANGERS	YES
ADJUSTABLE FEET	Yes
DRAWER CAPACITY	15KGS
DRAWER OPERATION	Soft close Pull to open

TECHNICAL DIMENSIONS

Dimensions in mm unless otherwise specified.
Tolerances (per material type) apply.

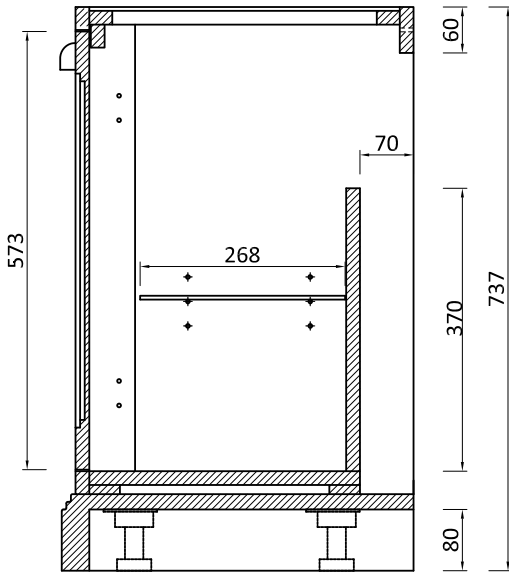
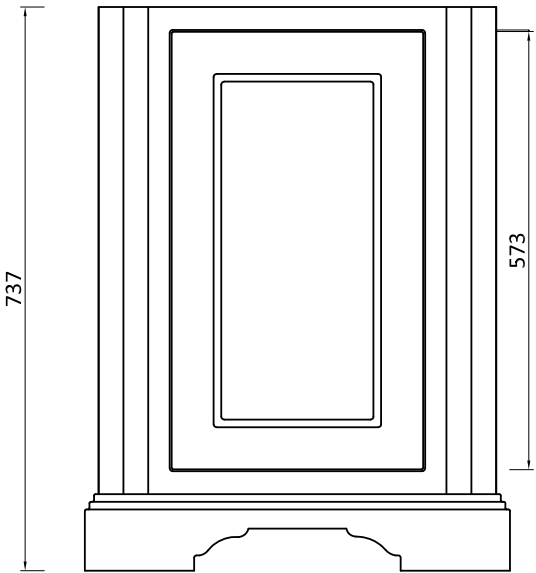
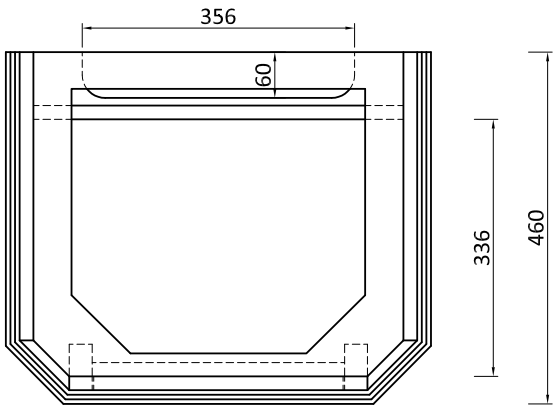

SPARES LIST

Only the parts labelled are available as spares.

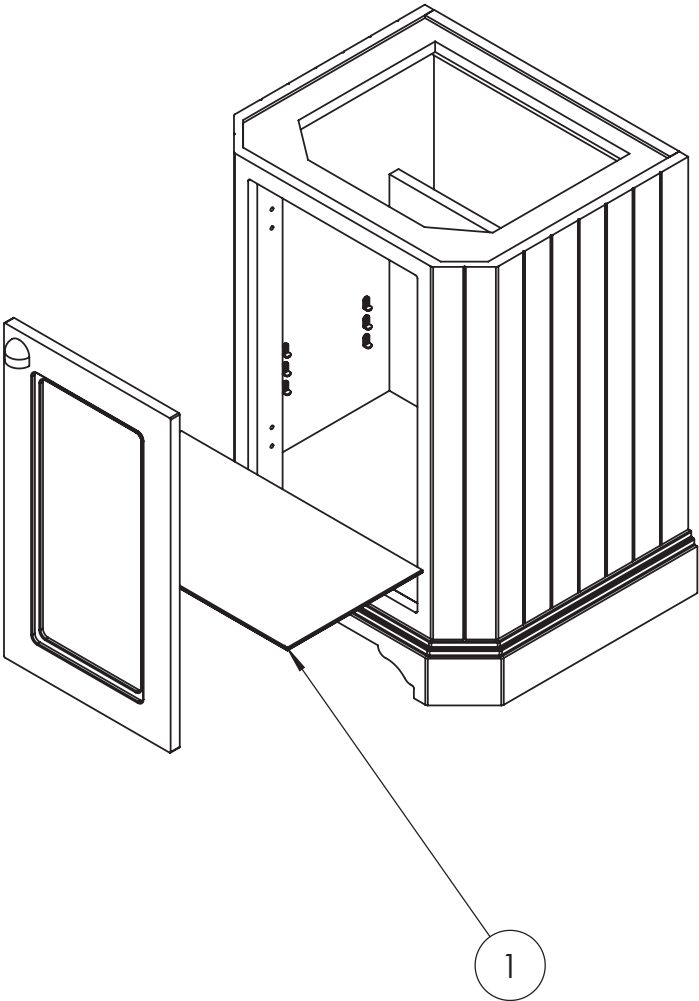

NUMBER	PART CODE	DESCRIPTION
1	SP1288	BB Spare glass shelf for FC12