

# PRODUCT DATA SHEET

Burlington®

PRODUCT CODE  
W3 BNKL

RANGE  
Victorian

DESCRIPTION  
Bath Overflow, Plug & Chain Brushed Nickel



CATEGORY	Brassware
WARRANTY DETAILS	15 Years
COLOUR	Brushed Nickel
FINISH APPLICATION	PVD
PRIMARY MATERIAL	Brass
SECONDARY MATERIAL	Plastic
INSTALL TYPE	Bath Mounted
PRODUCT WIDTH MM	72
PRODUCT HEIGHT MM	672
PRODUCT LENGTH MM	600
PRODUCT NET WEIGHT KG	0.38

PRESSURE (BAR)	0.2	0.5	1	2	3	4	5
PRIMARY FLOWRATE							
HANDSET FLOWRATE							
MASSAGE FLOW RATE							
AIR FLOW RATE							
WIRE FLOW RATE							
WATERFALL FLOW RATE							
MIST FLOW RATE							
HANDSPRAY FLOW RATE							

## TECHNICAL DIMENSIONS

Dimensions in mm unless otherwise specified.

Tolerances (per material type) apply.

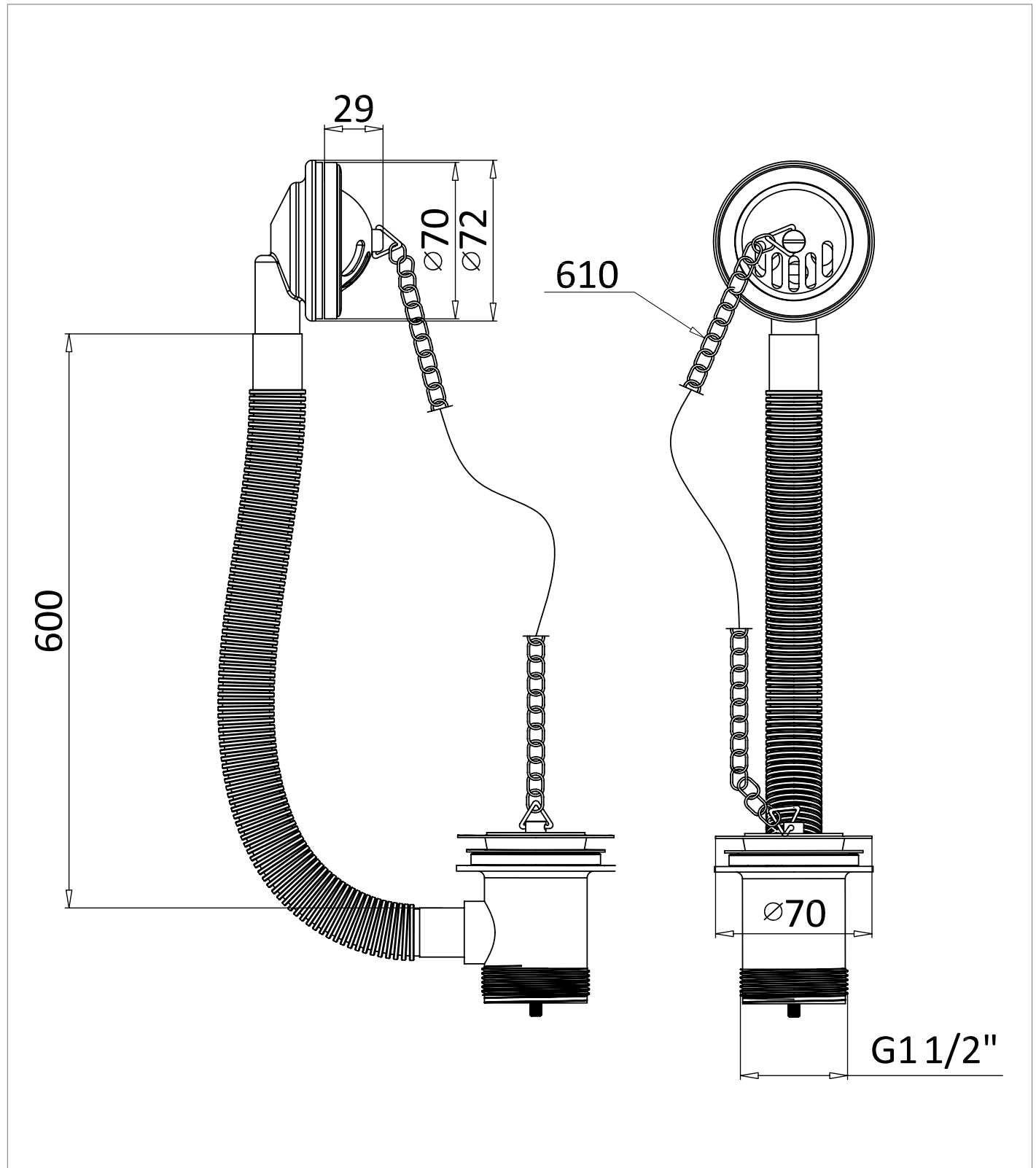

## SPARES LIST

Only the parts labelled are available as spares.

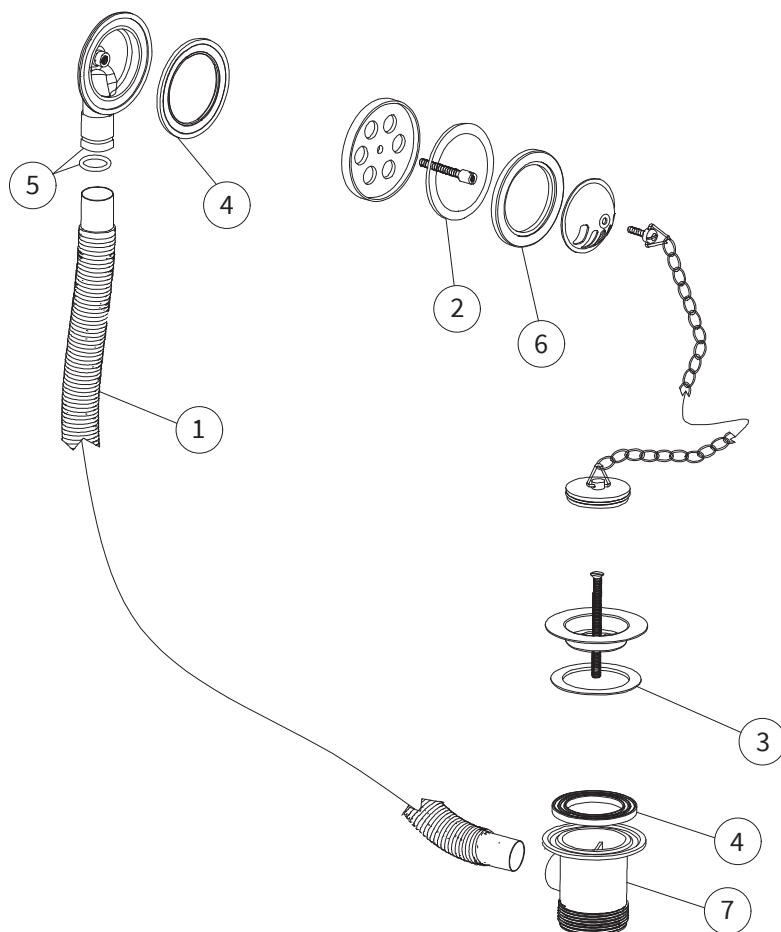

NUMBER	PART CODE	DESCRIPTION
1	SP1000	Flexible overflow pipe
2	SP1472	Overflow washer
3	SP1642	Waste gasket
4	SP222	Rubber washer
5	SP887	Overflow housing
6	SP108	Ceramic ring for all finishes products of Burlington exposed valve
7	SP224	Waste Housing