

**Tools required:**

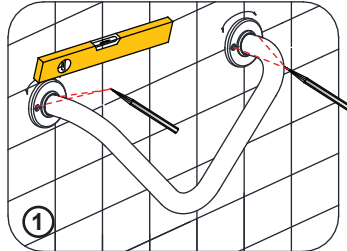

**1** Determine the final installation position, mark the fixing hole positions in pencil.

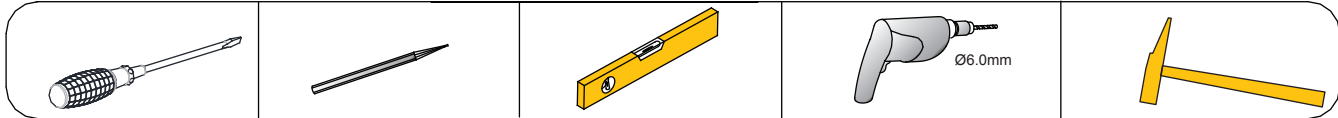
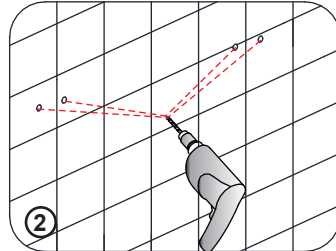

**2** Using a 6mm drill bit, drill holes on the marked positions.

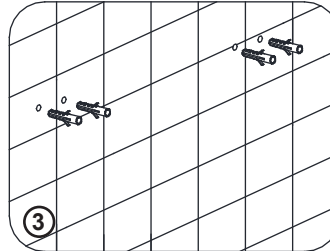

**3** Insert the rawl plugs into the drilled holes.

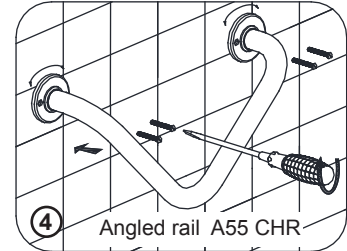

**4** Angled rail A55 CHR  
 Screw in the stainless steel screws to secure the base to the wall. Please ensure that the screw heads are parallel to the wall.

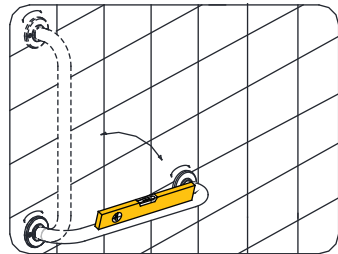

Straight rail A54 CHR  
 Note: The straight rail A54 can be installed vertically or horizontally.

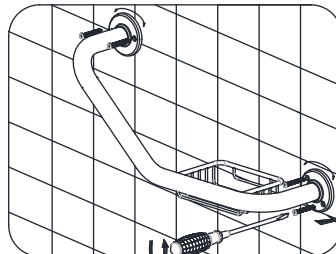

Angled rail with soap basket - right hand  
 A53 CHR

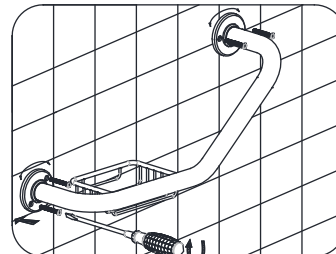

Angled rail with soap basket - left hand  
 A52 CHR

The product is 100% brass chrome plated with polished Stainless Steel Screws.  
 Suggest cleaning the product surface with cleanwater or soft detergent, and then dry with soft towel.  
 Please do not use any detergent containing hydrochloric acid or caustic chemicals.  
 Avoid scratching the surface with hard objects, and do not use a coarse cloth to wipe.  
 The product should be installed by a professional, following the recommended installation instructions.